

SEYMOUR ARM CAPACITOR STATION

CELISTA CREEK PASSIVE REFLECTOR SITE

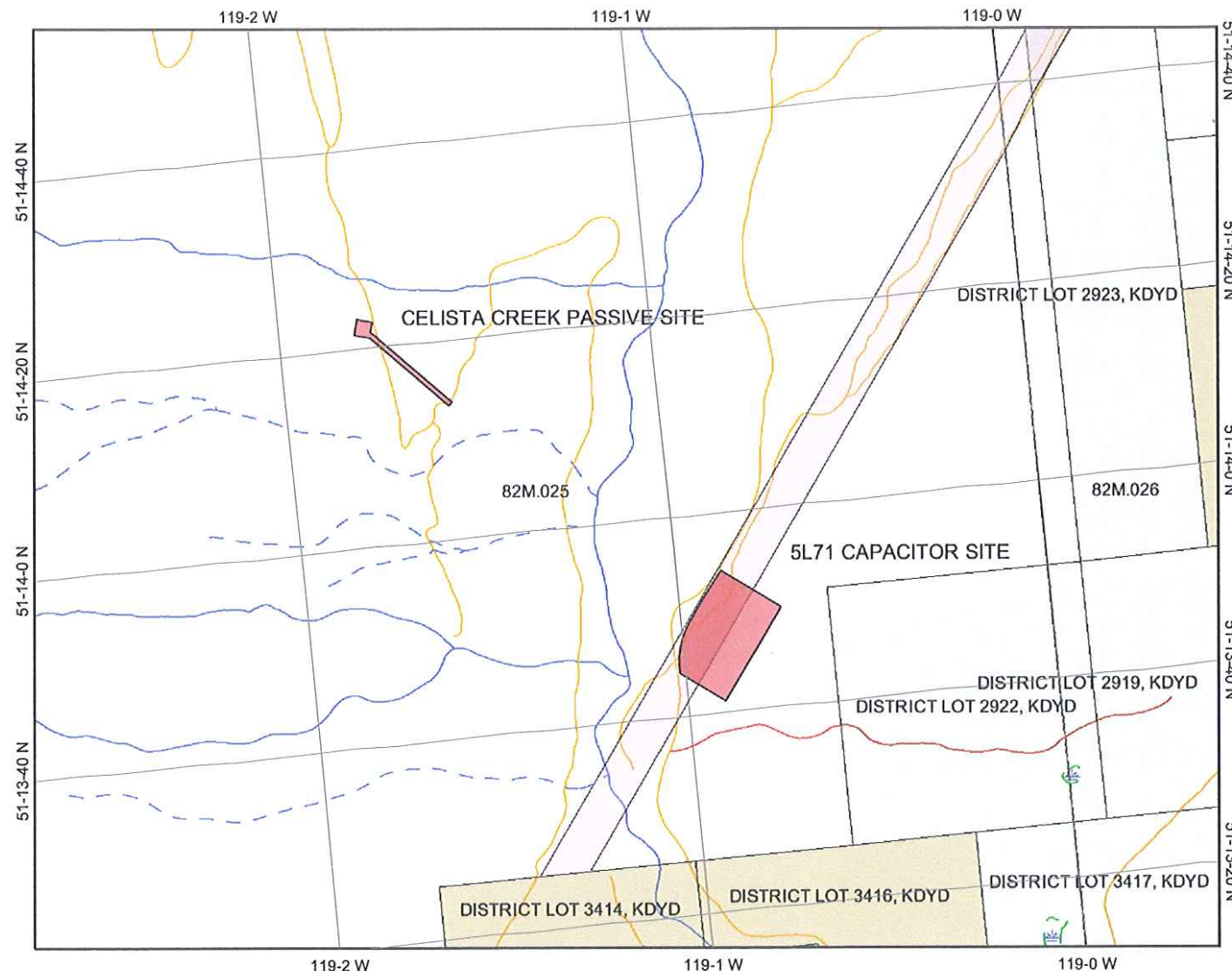

- ### Legend
- ☐ Land Act Right-of-Ways
 - ☐ Land Act Crown Grants
 - ☐ Survey Parcel Right of Ways
 - ☐ Surveyed Parcel Base - Cadastre
 - ☐ Transportation - Points (TRIM)
 - ☒ Helipad
 - ☒ Transportation - Lines (TRIM)
 - Airfield
 - Airport
 - Airstrip
 - Airport Abandoned
 - Ferry Route
 - Road (Gravel Undivided) - 1 Lane
 - Road (Gravel Undivided) - 2 Lanes
 - Road (Gravel Undivided) - U/C - 1 Lane
 - Road (Gravel Undivided) - U/C - 2 Lanes
 - Road (Paved Divided) - Not Elevated - 1 Lane Each Way
 - Road (Paved Divided) - Not Elevated - 2 Lanes Each Way
 - Road (Paved Divided) - U/C - Not Elevated - 2 Lanes Each Way
 - Road (Paved Undivided) - Not Elevated - 1 Lane
 - Road (Paved Undivided) - Not Elevated - 2 Lanes
 - Road (Paved Undivided) - Not Elevated - 4 Lanes
 - Road (Paved Undivided) - U/C - Not Elevated - 4 Lanes
 - Road (Unimproved)
 - Cut (Roadway)
 - Embankment/Fill (Roadway)
 - Trail
 - Bridge - Foot
 - Bridge - Trestle



Scale: 1:20,000

Map center: 51° 14' 3" N, 119° 1' 6" W

This map is a user generated static output from an Internet mapping site and is for general reference only. Data layers that appear on this map may or may not be accurate, current, or otherwise reliable. THIS MAP IS NOT TO BE USED FOR NAVIGATION.