

**TELUS CELL SITE
LOCATION 0260**

a: 15.24m at 316°
b: 15.24m at 46°
c: 15.24m at 136°
d: 15.24m at 226°
232m²

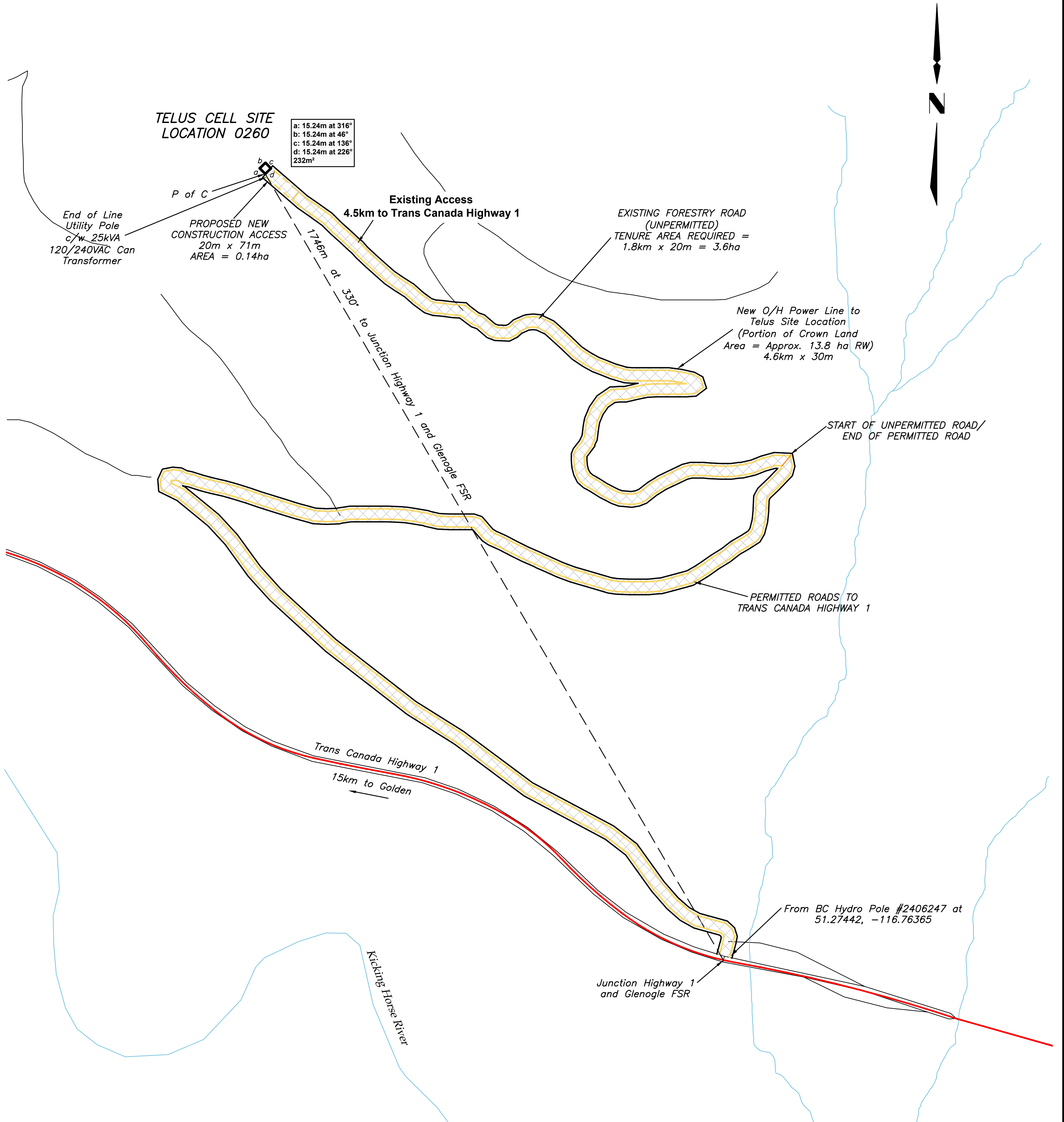

LEGEND:
All distances are in metres and decimals thereof.

- Denotes Proposed Powerline RW
- Denotes Proposed Access
- Denotes Private Land
- Denotes Crown Land
- Denotes highway
- Denotes 20m wide site access
- Denotes secondary road



COORDINATE TABLE NAD83 ZONE 11					
DESCRIPTION	NORTHING	EASTING	LAT.	LONG.	EL.
SITE BC0260	5681852.68	515503.48	51.28779	-116.77768	1568.42

Rev	Revision Description	Date(Y/M/D)	By
0	Original Plan Prepared	2012/09/05	MLE
1	Revised Scale add metres and bounds	2012/11/16	MRE



SKETCH PLAN SHOWING PROPOSED SITE
BC0260
EAST OF GOLDEN



The intended plot size of this plan is 432mm in width by 560mm in height when plotted at a scale of 1: 5000 (use C size sheet) Sheet 1 of 1



BCGS: 92H.018
FOCUS: BC0260 KEY PLAN REV. 1

www.focus.ca

S:\Southern BC_M5\010036579\00\Working\0260 East Golden\010036579-02-TSKP-R01.dwg 2012/11/26 11:33