

### ABBREVIATIONS

EHFBC=End Haul Full Bench Cut  
 EH3/4BC=End Haul 3/4 Bench Cut  
 CAF=Coarse Angular Fill T-toed in S-sideca  
 SDA=Soil Disposal Area  
 RW Landing=Right-of-Way Landing  
 RP/RT=Reference Point  
 (TSFA)=Reference to Terrain Stability  
 Field Assessment Report  
 Note: All other construction comments are designer recommendations only

### VOLUMES

P-Stn m.	L-Stn m.	Lyr1 Gnd	Lyr1 V. Cu. m.	Lyr2 Gnd	Lyr2 V. Cu. m.	Lyr3 Gnd	Lyr3 V. Cu. m.	SG Cut Cu. m.	SG Fill V. Cu. m.	Mass H. Cu. m.
0.0	0.0	OB	45.4		0.0		0.0	45.4	2.2	0.0
21.6	20.0	OB	75.7		0.0		0.0	75.7	1.0	43.2
50.2	40.0	OB	56.9		0.0		0.0	56.9	28.3	117.9
73.2	60.0	OB	0.0		0.0		0.0	0.0	178.9	146.5
92.4	80.0	OB	70.5		0.0		0.0	70.5	165.8	107.6
112.7	100.0	OB	97.6		0.0		0.0	97.6	102.6	12.3
133.3	120.0	OB								7.4
Pg. Tot.			346.1		0.0		0.0	346.1	478.7	
Cum. Tot.			346.1		0.0		0.0	346.1	478.7	

John Davidson  
 1503 Broadview CRT  
 Coquitlam, B.C., V1E 4S4

Access to :  
 Sec 20 TWP 28 Reg 6 W6M  
 Legal Subdivision 1, Meridian W6

### Access Road Plan View

### Curve Table

	C1	C2	C3	C4
Angle	71.9	80.0	14.7	12.4
Tangent	7.3	8.4	4.5	3.2
Arc. Len.	12.6	14.0	9.0	6.5
Radius	10.0	10.0	35.0	30.0
BC Stn.	26.6	42.0	76.9	125.3
EC Stn.	39.1	55.9	85.9	131.8

Page 1 of 1	13/05/06	P-Stn m.	L-Stn m.
		0.0	0.0
		21.6	20.0

Drawing 1

### CULVERTS

P-Stn m.	Cul DIA mm.	Cul Len m.	Cul Skew deg.
128.0	500	8.2	90
254.0	500	9.5	90

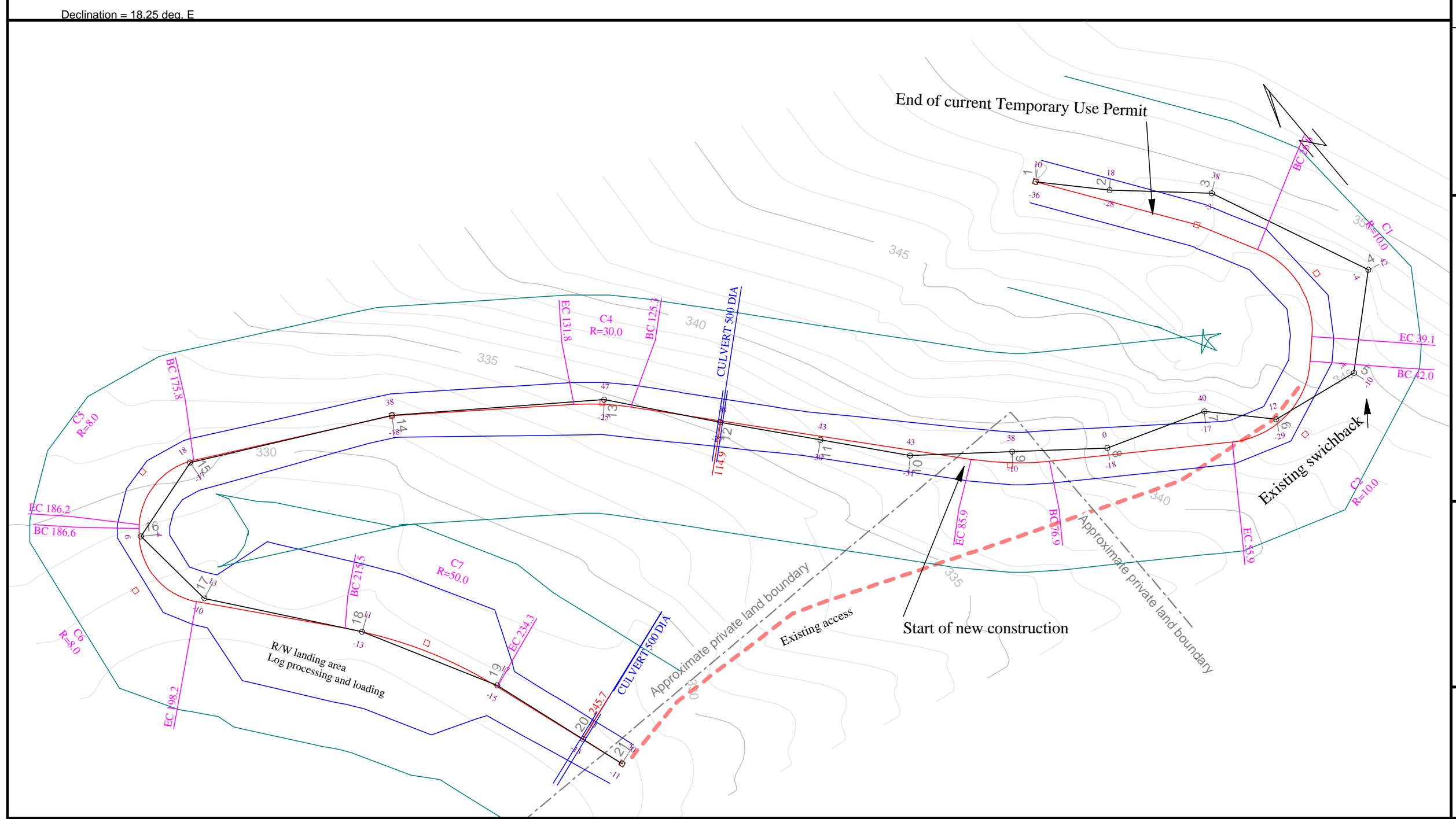

Declination = 18.25 deg. E

I certify that the work described herein fulfills the standards expected of a member of the Association of British Columbia Forest Professionals and that I did personally supervise the work.

PROFESSIONAL'S NAME

DATE SIGNED

Surveyed by: Landmark  
 Survey Completed: April 26, 2013  
 Designed by: Mark Wallace, RFT

