

SKETCH SHOWING PROPOSED UTILITY RIGHT OF WAY OVER PART OF DISTRICT LOT 281 YALE DIVISION YALE DISTRICT

BCGS 92H.057

BOOK OF REFERENCE	DESCRIPTION	AREA REQUIRED
	DISTRICT LOT 281 YALE DIVISION YALE DISTRICT	0.754 ha
	DISTRICT LOT 281 YALE DIVISION YALE DISTRICT	24.6 m ²
	DISTRICT LOT 281 YALE DIVISION YALE DISTRICT	29.1 m ²
	DISTRICT LOT 281 YALE DIVISION YALE DISTRICT	13.6 m ²
	DISTRICT LOT 281 YALE DIVISION YALE DISTRICT	230.2 m ²
	DISTRICT LOT 281 YALE DIVISION YALE DISTRICT	0.351 ha
	DISTRICT LOT 281 YALE DIVISION YALE DISTRICT	0.267 ha
	DISTRICT LOT 281 YALE DIVISION YALE DISTRICT	19.6 m ²
	TOTAL AREA	1.40 ha

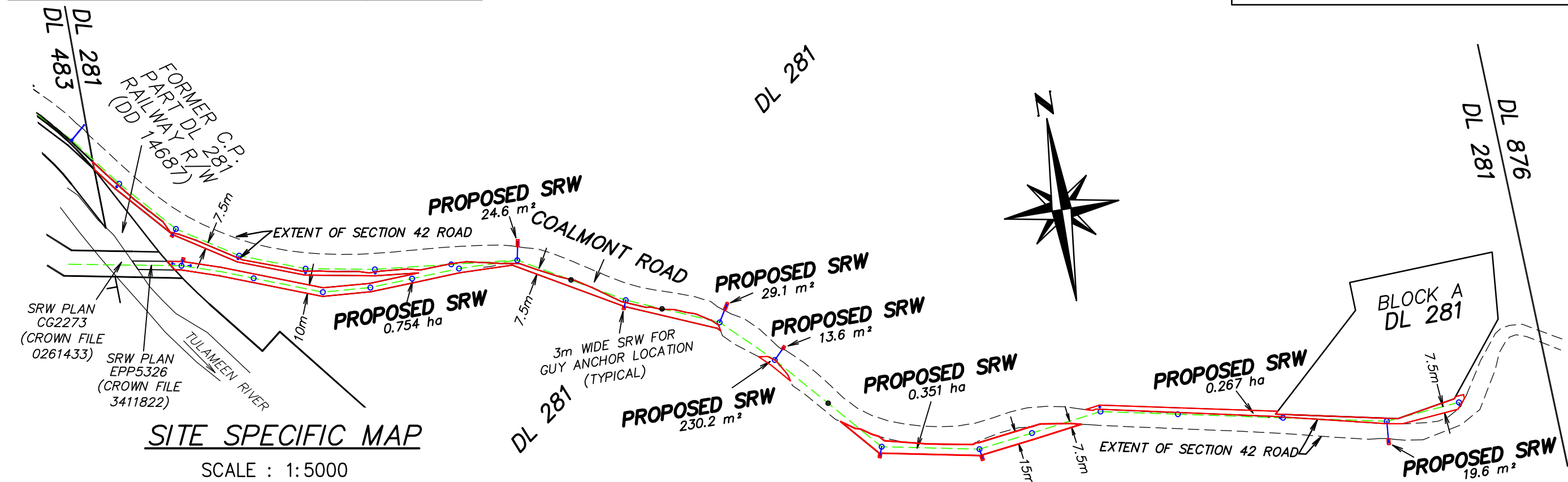
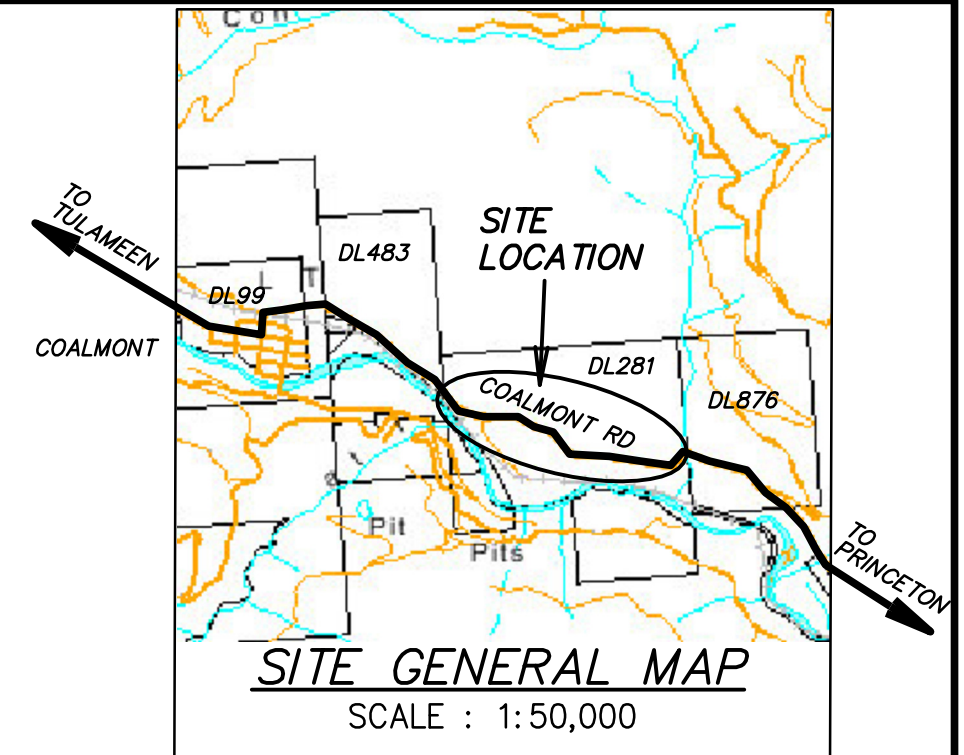

- DENOTES PROPOSED SRW OVER CROWN LAND
- - - DENOTES CENTRELINE OF OVERHEAD ELECTRICAL
- DENOTES POLE LOCATIONS
- DENOTES PROPOSED FORTISBC POLE LOCATIONS
- DENOTES EXISTING ANCHOR LOCATIONS

NOTE: DIMENSIONS AND AREAS SHOWN ARE BASED ON LAND TITLES OFFICE RECORDS AND ARE SUBJECT TO FINAL SURVEY.

McELHANNEY ASSOCIATES
PROFESSIONAL LAND SURVEYORS
 #102-130 NANAIMO AVENUE W.,
 PENTICTON, B.C. V2A 8G1

TEL: 250-492-7399 OUR FILE NO. 2422-03054-0
 FAX: 250-492-5488 OUR DRAWING NO. 3054-0-BASE-R2.DWG