

123°38'0"W

54°20'0"N

54°20'0"N

# SITE MAP

BCGS Mapsheet: 93J002

Lat/Long: 54° 0' 41.232" N 123° 38' 4.988" W

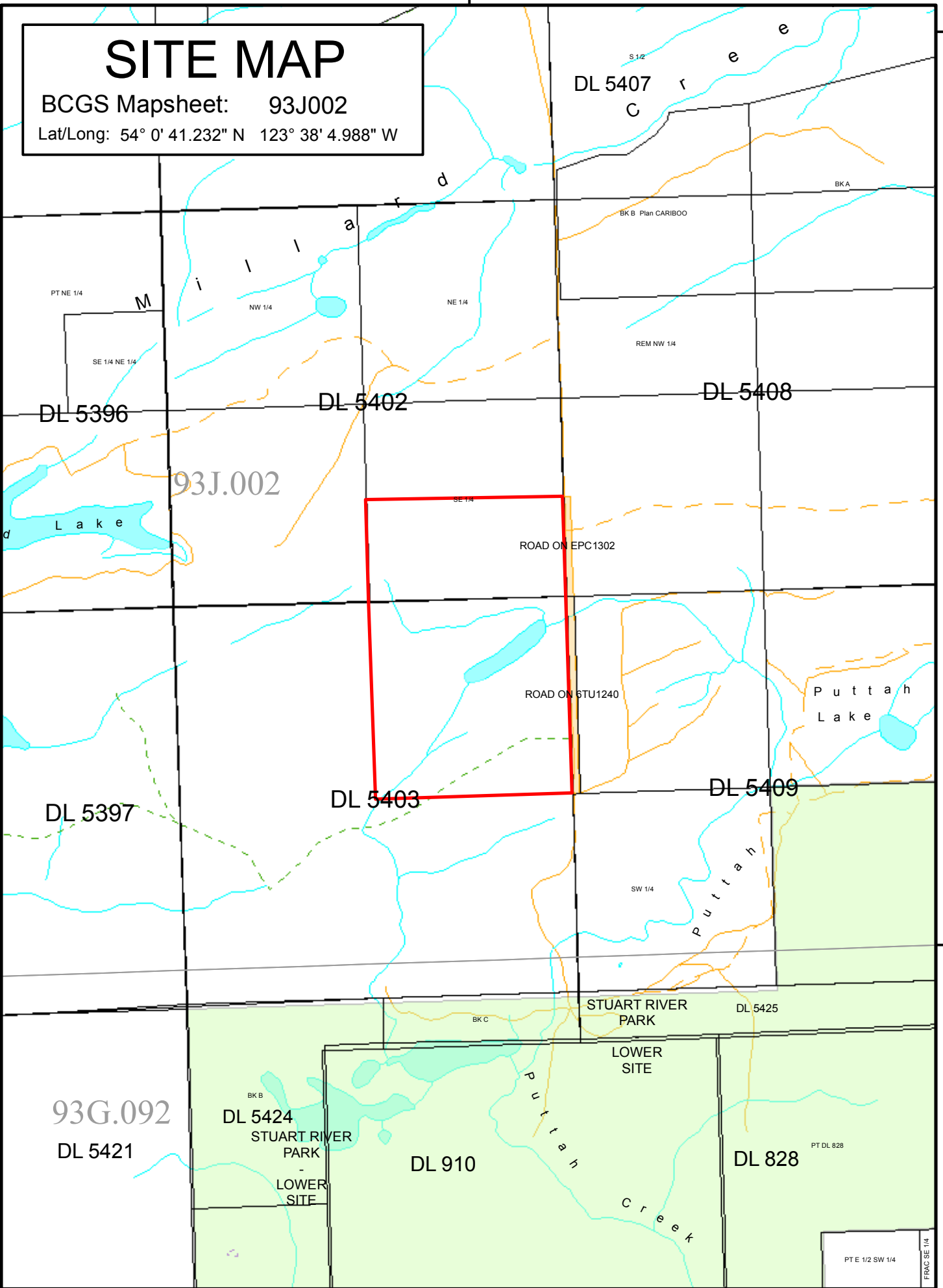

54°0'0"N

54°0'0"N

## File Number: 7409843

Site # 1 of 1 - APPLICATION Area = 97.63 Ha.

TYPE: CROWN GRANT

PURPOSE: AGRICULTURE

SUBTYPE: DIRECT SALE

SUBPURPOSE: EXTENSIVE

LOCATION: Sturgeon Point

ORTHO PHOTO YEAR: NA

Produced by  
Ministry of Natural Resource Operations  
Northern Service Centre  
FrontCounterBC  
Date: April 5, 2016

Scale: 1:20,000 \*

\* if printed on 8.5X14 page

Projection: BC Albers  
Datum: NAD 83

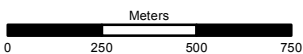

### Legend

- Crown Land Application
- Primary Survey Parcel
- Subdivision
- Municipality
- Surveyed Rights of Way**
  - Surveyed Road R/W
  - Gas/Oil R/W District Lot
  - Power Transmission R/W
  - Gas/Oil R/W
  - Telecom R/W District Lot
  - Miscellaneous R/W
- Transportation Corridors**
  - Highway
  - Railway
  - Surveyed Road R/W
- Protected Areas**
  - Provincial Park
  - Protected Area
  - OIC Ecological Reserve
  - Recreation Area
- Base Mapping Features (20K)**
  - River or Stream
  - River or Stream - Dry
  - Lake
  - Reservoir - Definite
  - Glacier/Icefield
  - Contour - 20m interval
- Transportation - Lines (20K)**
  - Airfield
  - Road
  - Forest Service Road
  - Road Permit
  - Trail
  - Rail Line

All measurements are approximate.