

Metes and Bounds Description:

Beginning at the NW corner of DL 3415,
 thence 323°16'06" for a distance of 2288m, more
 or less, to the point of commencement (POC),
 Thence 270° for a distance of 50m,
 Thence 0° for a distance of 50m,
 Thence 90° for a distance of 50m,
 Thence 180° for a distance of 50m,
 to the point of commencement
 containing an area of 0.25 hectares, more or less.

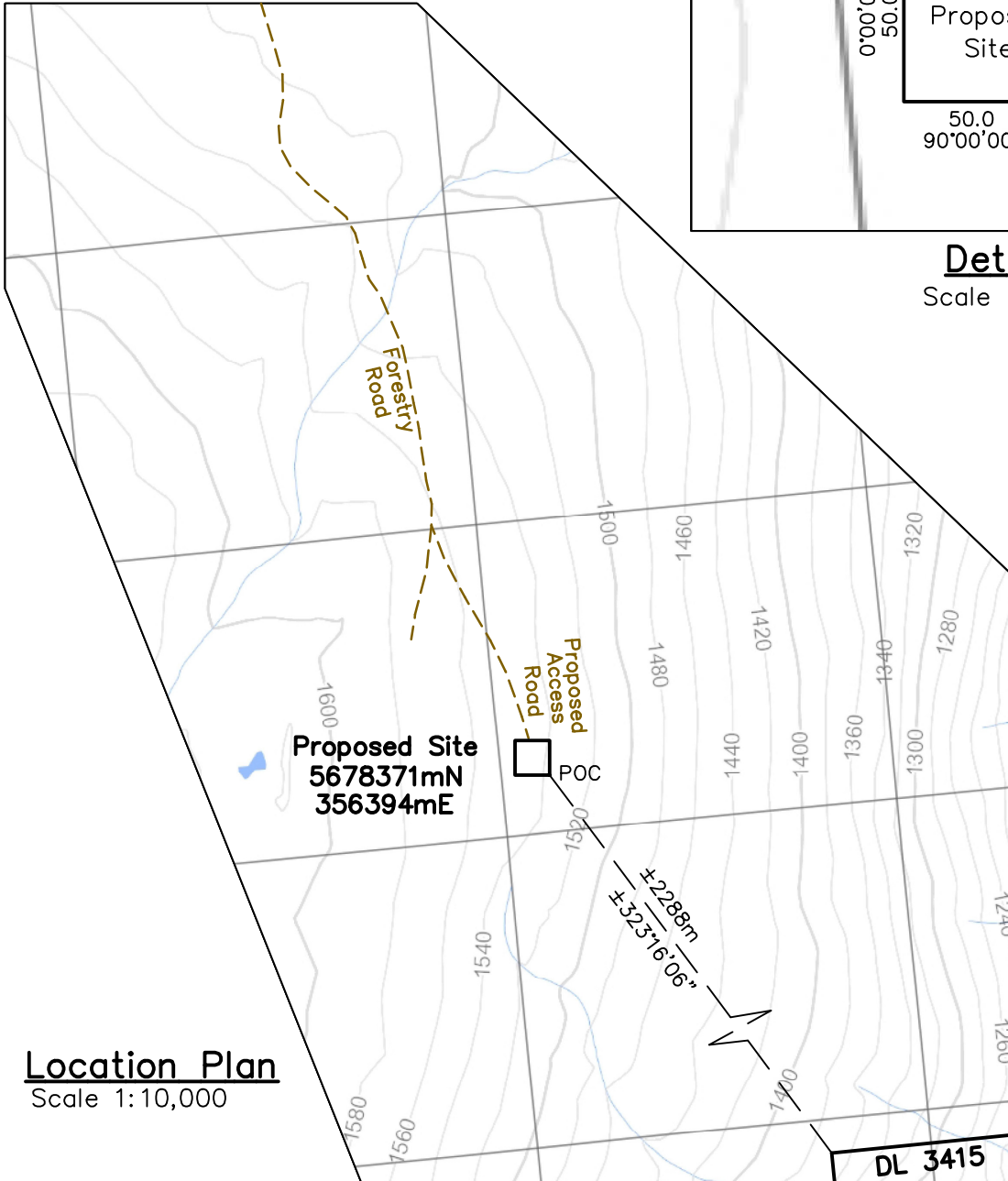

Location Plan
 Scale 1:10,000

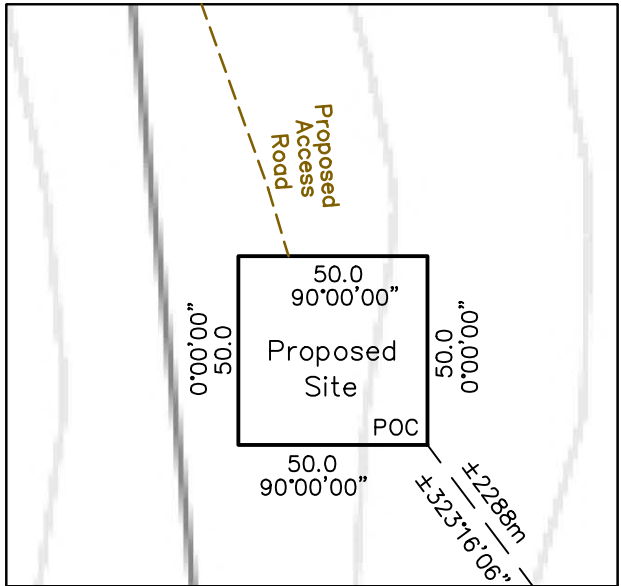

Detail
 Scale 1:2500



Note: Bearings & coordinates refer to UTM Zone 11N NAD83(CSRS). Contours are approximate and are from TRIM data.

Sketch Plan to Accompany
 Application for Crown Tenure over
 Unsurveyed Crown Land for Proposed
 Site in the Vicinity of Seymour Arm

BROWNE JOHNSON LAND SURVEYORS
 B.C. AND CANADA LANDS
 SALMON ARM, B.C. Ph.250-832-9701
 File: 309-16 July 21, 2016