

127°39'30"W

55°13'0"N



55°13'0"N

Subject

093M022

127°39'30"W

Scale: 1:2,500
Type: LEASE
Sub Type: STANDARD LEASE
Purpose: RESIDENTIAL
Subpurpose: RURAL RESIDENTIAL

-  Application Area
-  Indian Reserves
-  Parks and Protected Area



Referral Map

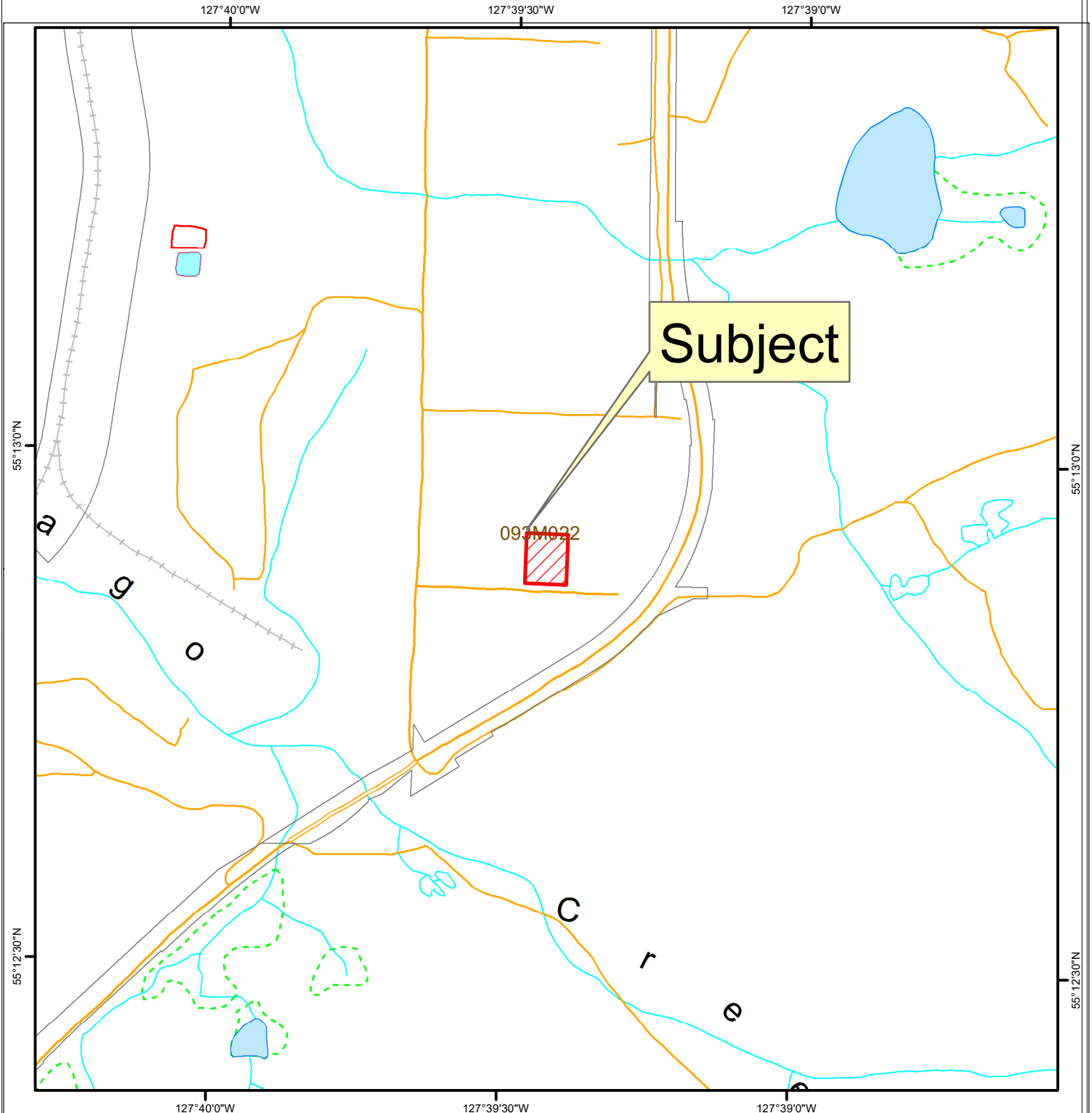

Date: 04 Jun 2018
Area: 0.7 ha



Scale: 1:10,000
 Type: LEASE
 Sub Type: STANDARD LEASE
 Purpose: RESIDENTIAL
 Subpurpose: RURAL RESIDENTIAL

-  Application Area
-  Indian Reserves
-  Parks and Protected Area



Referral Map

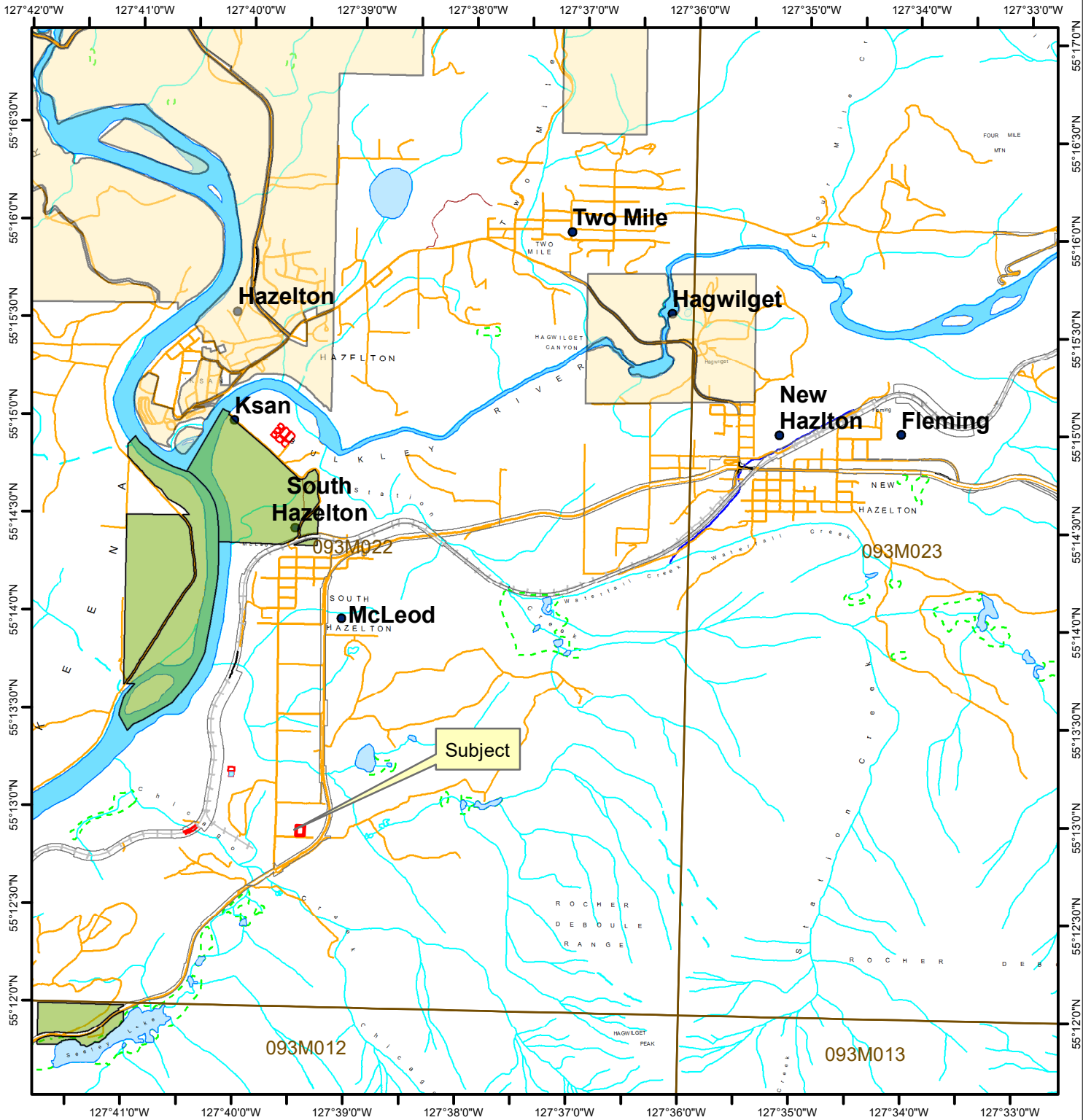

Date: 04 Jun 2018
 Area: 0.7 ha



Scale: 1:52,441
 Residential Lease

-  Application Area
-  Indian Reserves
-  Parks and Protected Area

Referral Map



Date: 06 Jun 2018
 Area: 0.7 ha +/-